

Overview

- For non-corrosive gasses and liquids
- Class 1 according to EN 837-1
- Wetted parts: Brass



Picture similar

Technical data

Housing

Nominal size	100 mm
Case material	Stainless steel 1.4301 / AISI 304
Bezel ring material	Stainless steel 1.4301 / AISI 304
Window material	Instrument glass
Window gasket	Elastomer
Protection rating (EN 60529)	IP65
Dial	White, Aluminium
Pointer	Black, Aluminium
Movement material	Brass

Temperature

Ambient temperature	-20°C ... +70°C
Storage temperature	-40°C ... +70°C
Media temperature	-20°C ... +70°C

Wetted parts

Process connection material	Brass
-----------------------------	-------

Wetted parts

Bourdon tube	Bronze
--------------	--------

Performance

Accuracy according to EN 837-1	Class 1
Min. measuring range	0 ... 0.6 bar
Max. measuring range	0 ... 60 bar
Type of pressure	Gauge Vacuum Compound
Pressure limitation	Steady: 100 % of full scale value Fluctuating: 90 % of full scale value Short time: 130 % of full scale value
Thermal drift (reference: +20 °C)	± 0.4 % FS/10K

Weight

Gauge	510 g unfilled 810 g filled
-------	--------------------------------

Dimensional drawings (mm)

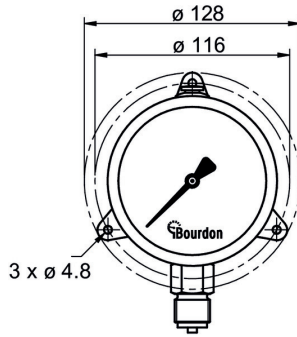
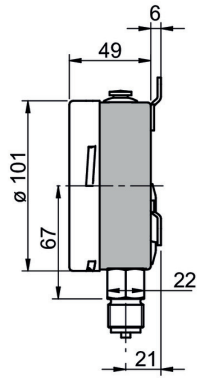

Type A

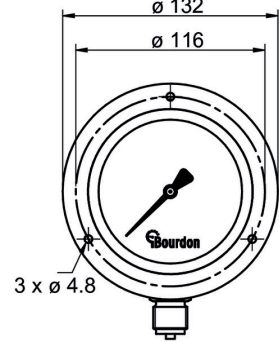
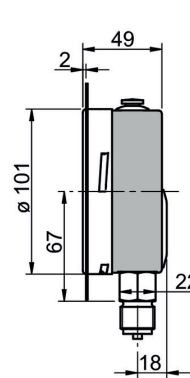

Type C

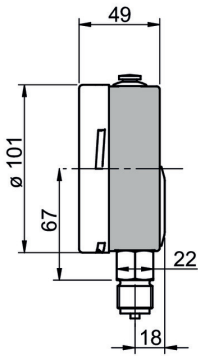

Type D

Measuring ranges

Code	Bar	Code	kPa	Code	kg/cm ²	Code	psi
B58	-0.6 ... 0	D58	-60 ... 0	F58	-0.6 ... 0		
B59	-1 ... 0	D59	-100 ... 0	F59	-1 ... 0	H59	-30" Hg ... 0
B72	-1 ... 0.6	D72	-100 ... 60	F72	-1 ... 0.6	H73	-30" Hg ... 15
B74	-1 ... 1.5	D74	-100 ... 150	F74	-1 ... 1.5	H75	-30" Hg ... 30
B76	-1 ... 3	D76	-100 ... 300	F76	-1 ... 3	H2C	-30" Hg ... 60
B77	-1 ... 5	D77	-100 ... 500	F77	-1 ... 5	H78	-30" Hg ... 100
B79	-1 ... 9	D79	-100 ... 900	F79	-1 ... 9	H79	-30" Hg ... 150
B81	-1 ... 15	D81	-100 ... 1 500	F81	-1 ... 15	H81	-30" Hg ... 220
B82	-1 ... 24	D82	-100 ... 2 400	F82	-1 ... 24	H82	-30" Hg ... 300
B12	0 ... 0.6	D12	0 ... 60	F12	0 ... 0.6	H13	0 ... 10
B15	0 ... 1	D15	0 ... 100	F15	0 ... 1	H15	0 ... 15
B16	0 ... 1.6	D16	0 ... 160	F16	0 ... 1.6	H1C	0 ... 20
B18	0 ... 2.5	D18	0 ... 250	F18	0 ... 2.5	H17	0 ... 30
B19	0 ... 4	D19	0 ... 400	F19	0 ... 4	H19	0 ... 60
B20	0 ... 6	D20	0 ... 600	F20	0 ... 6	H21	0 ... 100
B22	0 ... 10	D22	0 ... 1 000	F22	0 ... 10	H22	0 ... 160
B24	0 ... 16	D24	0 ... 1 600	F24	0 ... 16	H23	0 ... 200
B26	0 ... 25	D26	0 ... 2 500	F26	0 ... 25	H25	0 ... 300
B27	0 ... 40	D27	0 ... 4 000	F27	0 ... 40	H26	0 ... 400
B29	0 ... 60	D29	0 ... 6 000	F29	0 ... 60	H27	0 ... 600

Ordering reference

Ordering key - Configuration possibilities see website

	MMD5	-	#	#	#	.	###
Product	MMD5						
Case							
Case 1.4301 (304), bottom connection, back fixing for wall mounting				A			
Case 1.4301 (304), bottom connection, front flange, 3 holes for panel mounting				C			
Case 1.4301 (304), bottom connection				D			
Process connection							
G 1/4						2	
G 1/2						3	
Damping fluid							
without							0
BH1, Glycerin 86 %							1
BH2, Glycerin 99 %							2
Measuring range⁽¹⁾							
bar (EN)							Bxx
kPa (EN)							Dxx
MPa (EN)							Exx
kg/cm ² (EN)							Fxx
psi (ANSI)							Hxx
bar/psi (EN)							Kxx

(1) Available standard measuring ranges, see table in section Measuring ranges. For ranges not listed, please enquire.

Options

Adjustable micrometric pointer ⁽¹⁾	0678	2.1 Certificate	Q001
Laminated safety glass	0751	2.2 Certificate	Q002
Polycarbonate (Makrolon) window	0753	3.1 Calibration certificate 5 pts (rising)	Q008
Red index pointer on the dial	0051	3.1 Calibration certificate 5 pts (EN837)	Q009
Polycarbonate with red indexpointer, adjustment with removable button	0053	3.1 Calibration certificate 10 pts (EN837)	Q010
Red index pointer, magnetic adjustment	0054		

(1) P ≥ 1.6 bar